

INSTALLATION INSTRUCTIONS

APPLICATION:

2005-08 Honda Odyssey

WARNING

Although this hitch is designed to safely tow its rated load, we recommend that you consult your vehicle owner's manual for possible manufacturer's recommendations or limitations. Always follow the manufacturer's installation instructions and always install on the specified vehicle. Before installing hitch, check that the attachment points are in good condition.

Failure to follow these guidelines will void warranty. Any modifications to this hitch will void warranty.

CLASS III

WEIGHT CARRYING HITCH CAPACITY

**3500 LBS. MAXIMUM TRAILER WEIGHT
350 LBS. MAXIMUM TONGUE WEIGHT**

WEIGHT DISTRIBUTING HITCH CAPACITY

**5000 LBS. MAXIMUM TRAILER WEIGHT
500 LBS. MAXIMUM TONGUE WEIGHT**

Trailer brakes are recommended for
towing loads in excess of 1500 lbs.

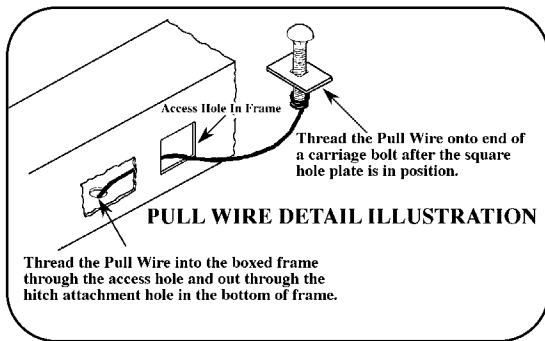

COMPLETE PARTS LIST

Part	Description	Quantity
1.	Receiver Assembly	(1)
<i>HARDWARE KIT #112338</i>		
2.	373202 12mm x 1.25 x 40mm Cl 10.9	(4)
3.	373005 1/2 Conical Washer	(4)
4.	279301 7/16-14 x 1-1/2 Carriage Bolt GR 5	(1)
5.	279408 Square Hole Plate	(1)
6.	221305 7/16 Conical Washer	(1)
7.	186103 7/16-14 Hex Nut	(1)
8.	476201 Pull Wire	(1)
9.	112339 Instruction Sheet	(1)
<i>T CONNECTOR</i>		
10.	30002051 T Connector Assembly	(1)

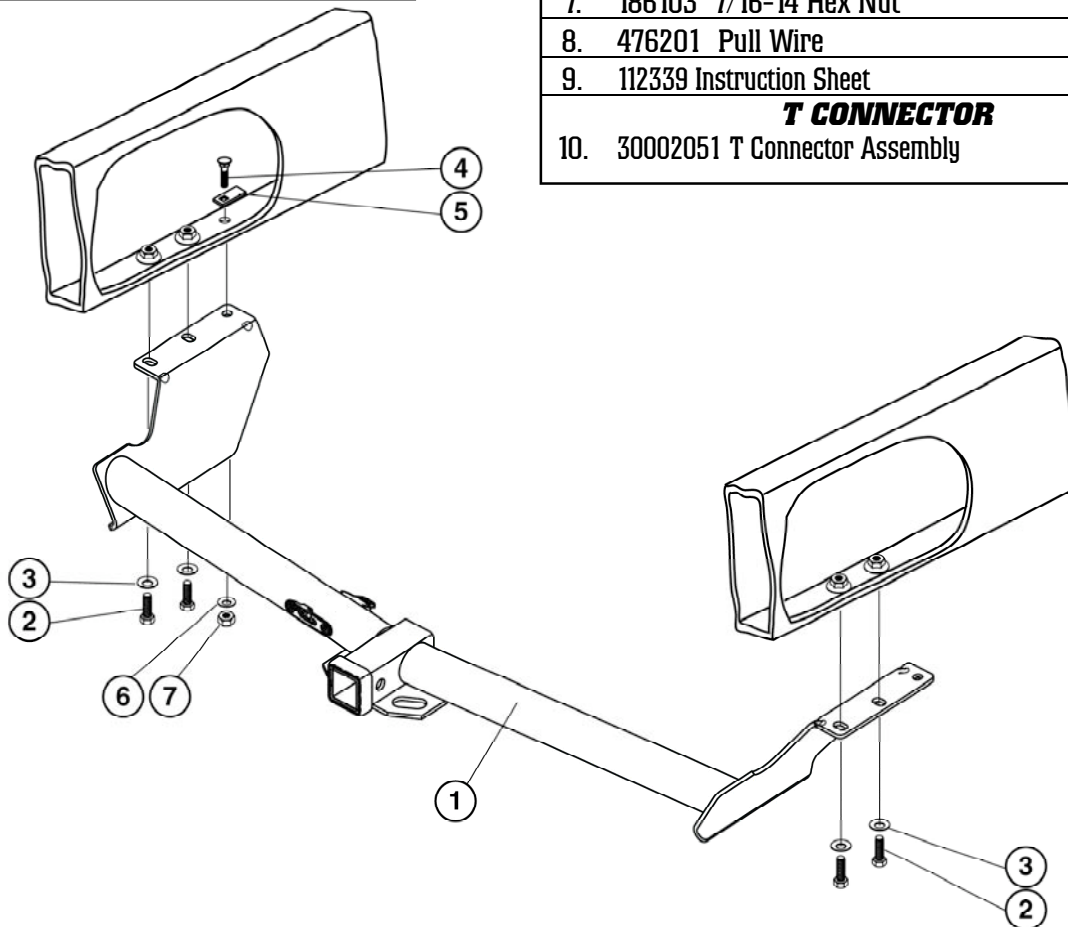

1. Read instructions thoroughly before beginning.
2. Open the rear hatch. Remove the plastic threshold by unscrewing the cargo net knobs that secure it in place. Using a plastic trim panel removal tool, remove the rear passenger's side cargo area trim panel to expose the electrical junction box (Fig. 1).
3. Pull the rear cargo area liner (carpet) back from the passenger side to expose the rubber grommet located in the right side of the floor (Fig. 2). Remove grommet and set aside for later use.
4. Plug the grey matting connector on the Hitch Wiring Harness into the upper right side of the vehicle's electrical junction box (Fig. 1). Locate the established ground next to the junction box and mount the white wire (Fig. 3).
5. Route the hitch wiring harness extension up from under the vehicle feeding the small connector through the hole. Continue routing up to the hitch wiring harness box and plug the extension into the mating connector on the hitch wiring harness making sure that the locks are fully engaged.
6. Secure the hitch wiring harness box into position on the flat surface under the vehicle's electrical junction box using the provided double-sided tape.
7. Carefully slit the grommet removed in step 3, allowing the wire harness to pass through the hole when the grommet is secured back to its proper location.
8. Using black electrical tape position the convoluted tubing on the under side of the vehicle near the grommet to help protect the exposed wiring.
9. Locate the fuse access panel below the passenger side glove box (Fig. 4). Insert the provided 7.5 amp fuse into position number 5. Replace fuse access panel.



Fig. 1



Fig. 2



Fig. 3

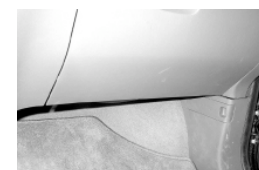

Fig. 4

Hitch Installation

1. Locate two threaded holes near the end of each vehicle side frame. These holes will be two of the attachment points for each of the hitch frame brackets.
2. Position the hitch assembly up against the bottom of the vehicle side frame, so that the rear two holes in the hitch frame brackets are lined up with the two threaded holes in each frame. Bolt hitch in place at these holes using the 12mm bolts and conical washers supplied with the hitch.
3. On left frame, position the square hole plate #5 and 7/16 carriage bolt #4 into the boxed frame through the access hole just forward of the hitch frame bracket, using the pull wire. See Pull Wire Illustration. Position over the forward hole in hitch frame bracket and pull the carriage bolt down through hole in frame and hitch frame bracket. Bolt hitch in place as illustrated.
5. Tighten the 12mm bolts to 75 ft. lbs. torque and the 7/16" bolts to 55 ft. lbs. torque. Failure to tighten bolts as described may result in fastener loss or failure.
6. Plug the remaining connector of the installed harness into the mating connector on the inward side of the hitch once installed. Press the connectors firmly together, ensuring that the locking tabs engage.
7. Confirm correct operation of the 4-Flat connector by using a test light or a properly equipped trailer.
8. Secure any loose wires under the vehicle using cable ties. Return trim panel, cargo cover, cargo net and threshold to their original positions.

WARNING: Use only a 5/8" diameter hitch pin with locking device to secure a ball mount in this receiver.

NOTE: Some states require a clear view of license plates. Remove trailer ball and/or ball mount when not in use if it restricts view.

For information regarding the installation of this product, go to: www.towingsupport.com
or Email us at: tech@towingsupport.com or Call our Technical Support Team at: 1-800-344-3230

This product complies with regulation V-5, C.S.A Standard D-264 and safety requirements for connecting devices and towing systems of the State of New York